

WHAT'S IN THE BOX

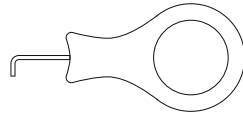

Grille Puller

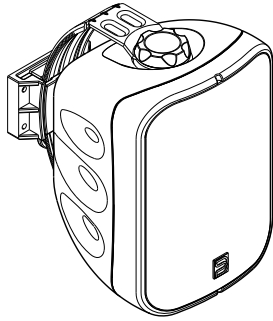

Bracket Screws

IMPORTANT

- Download the latest BSP500 Owner's manual from the Manual/Downloads tab of www.bluesoundprofessional.com/product/BSP500
- Visit support.bluesound.com for further assistance and information about getting the most out of the BSP500.

CONNECT

ETHERNET CABLE

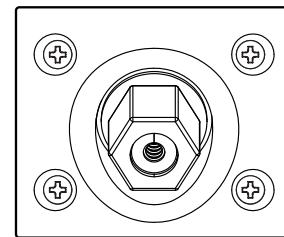
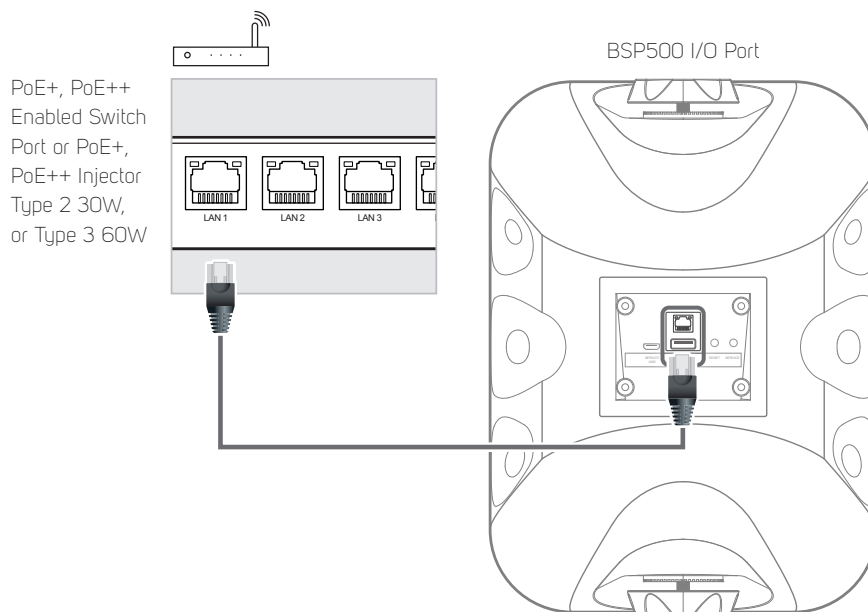

To access rear I/O Port:

Remove 4 screws holding I/O plate. Use screwdriver edge or sharp knife to lift plate. Pass Ethernet cable through grommet and hole to connect cable, before re-attaching I/O plate for proper operation.

DOWNLOAD

BluOS CONTROLLER APP

The BluOS Controller App for Apple iOS devices (iPhone, iPad, iPod), Android devices, Kindle Fire and Windows or Mac desktops are available for download from their respective App stores.



Launch the BluOS Controller App to configure your BSP500 as well as explore everything from your streaming music services, internet radio stations, networked music collections and favorites with quick and easy single-search discovery.